

- 1,478 SF Office/Flex Space Available
- 100% Sprinkled

# 2700 East 28th Street

hillcrestdevelopment.com

For information regarding leasing or renovations at  
2700 E. 28th Street, please contact:

**Joe Klein 612-623-2470**  
JoeK@hillcrestdevelopment.com

**Charlie Nestor 612-623-2475**  
CharlieN@hillcrestdevelopment.com

**Emily Claridge 612-623-2485**  
EmilyC@hillcrestdevelopment.com

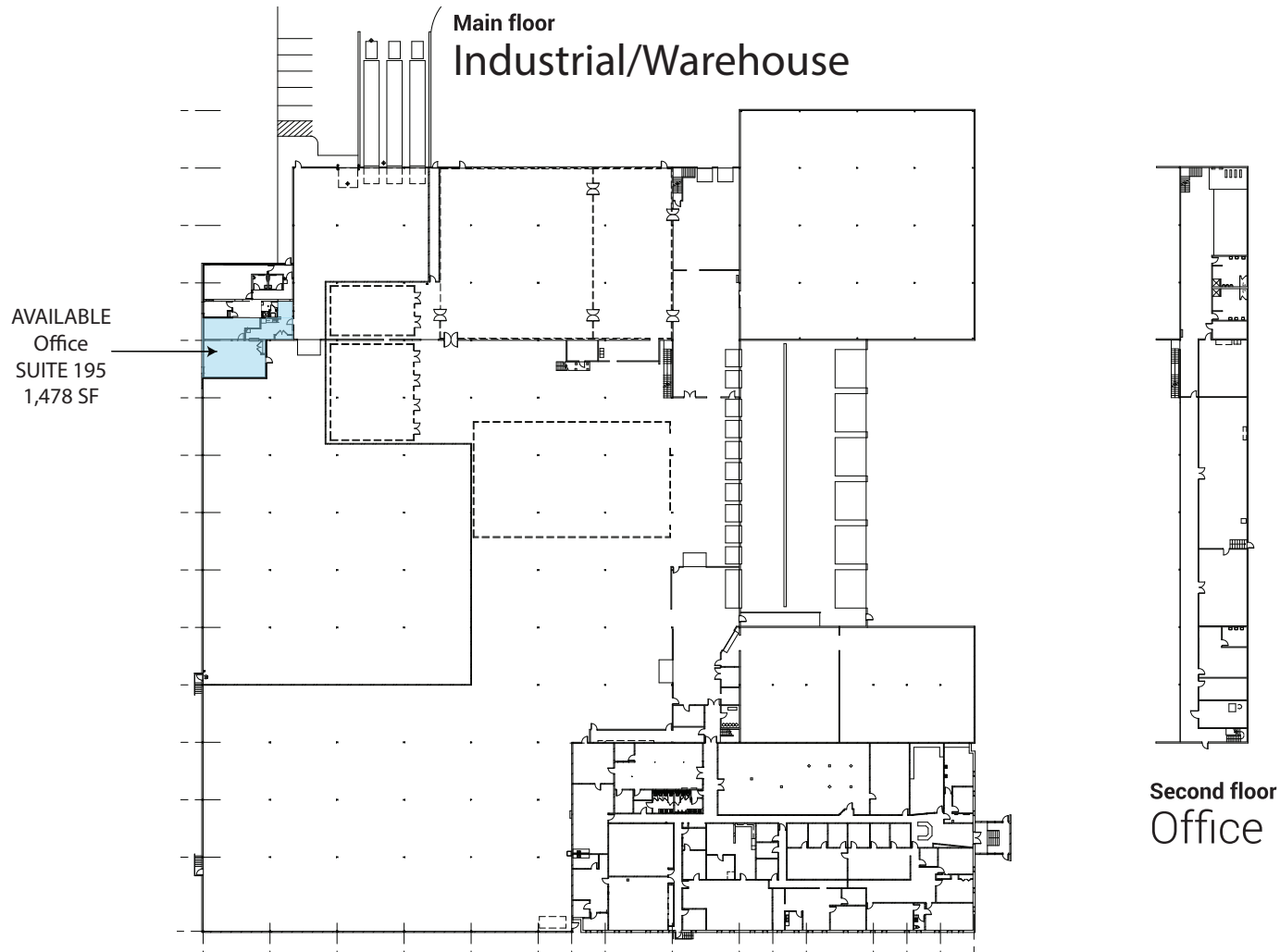

2700 E 28th Street  
Minneapolis, MN 55406